

**Exploded view**

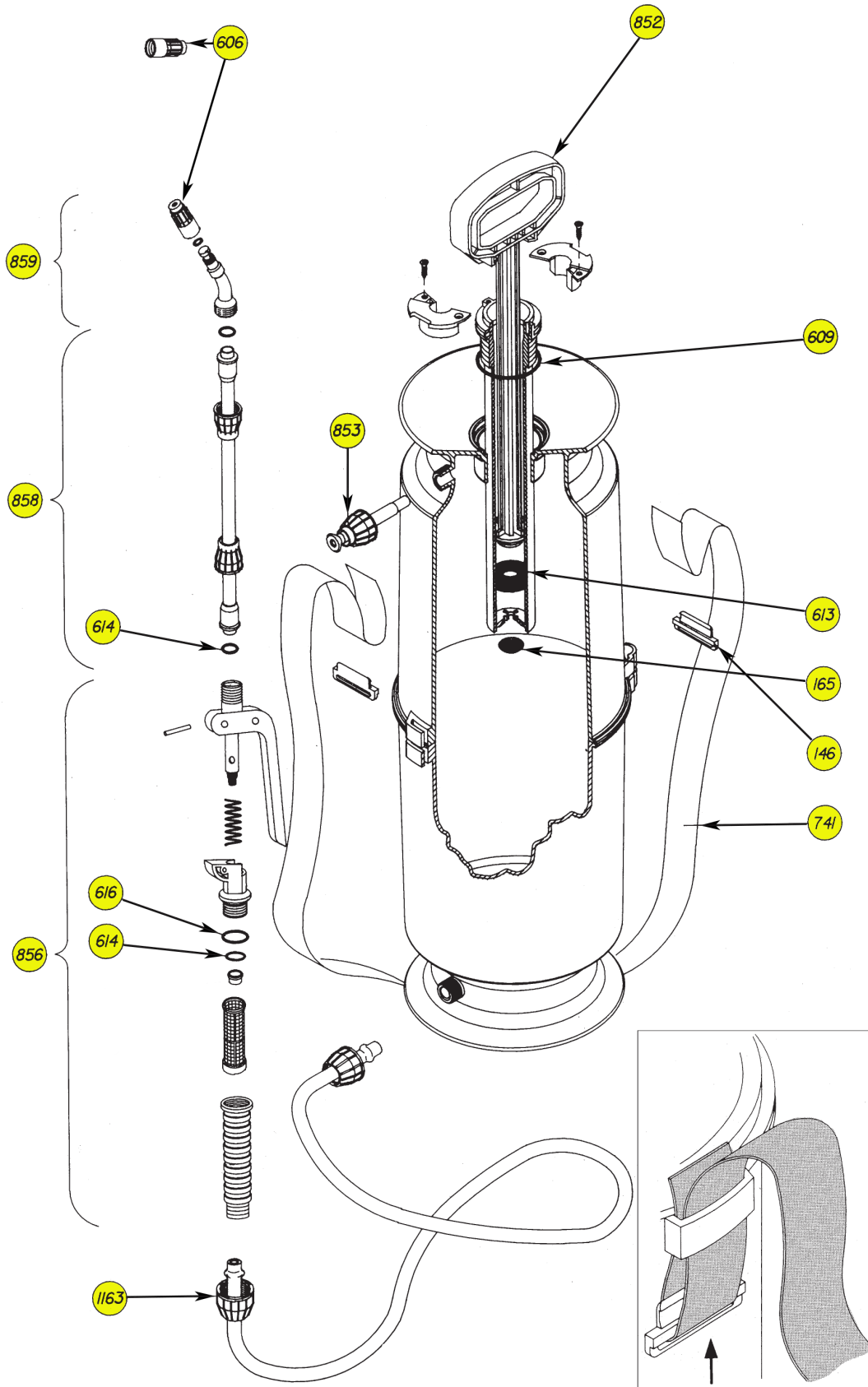

Pos	Description
146	Strap holder
165	Joint for pump
606	Bozzle
613	Lip seal
614	O-ring AN8
616	O-ring AN14
741	Strap with buckle
852	Complete pump
853	Safety valve
856	Complete handle
858	Lance tube
859	Elbow with nozzle
1163	Pipe