

The dosing system is delivered on a tamper-evident screwing cap. At the first use, the dosing-system goes on the bottle.

At the first use, the sealing-ring breaks and the screwing cap dissociates oneself from the dosing system. You only have to press on the side of the bottle to dose and then to pour the product.

When the bottle is empty, it is impossible to use the dosing system once again.

General Information

- Ordering numbers : DOSY JE C BLA
- Weight : 11.00 gr
- Color : white
- Dimensions : diameter 38 mm / height 83 mm

Neck : G141

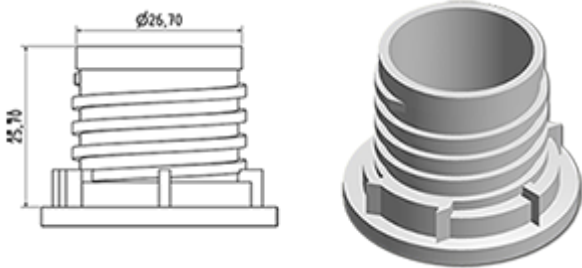

Standard packaging :

- 870 pcs per box
- Dimensions : 60 x 40 x 31 cm
- Gross weight : 10.35 Kg

Photo



Material

Pos	description	Material
1	Cap	HDPE
2	Tube	PP
3	topette	LDPE

